

OptiMix 4000 – fast and efficient mixing

The key to quality feed



The ANDRITZ OptiMix paddle mixer is fast and efficient. The design of the OptiMix trough and paddles reduce the mixing time while ensuring a homogeneous mixture with coefficient of variation (CV) below 5%.

The ANDRITZ OptiMix has been designed for dual rotation via VSD. When changing direction between every batch, a clean mixer aggregate can be obtained. The wiring and other items are integrated into the frame, making it easy to clean and maintain

the mixer. A ladder is attached to the end of the mixer to provide easy access to the OptiMix.

OptiMix 4000

The key to quality feed

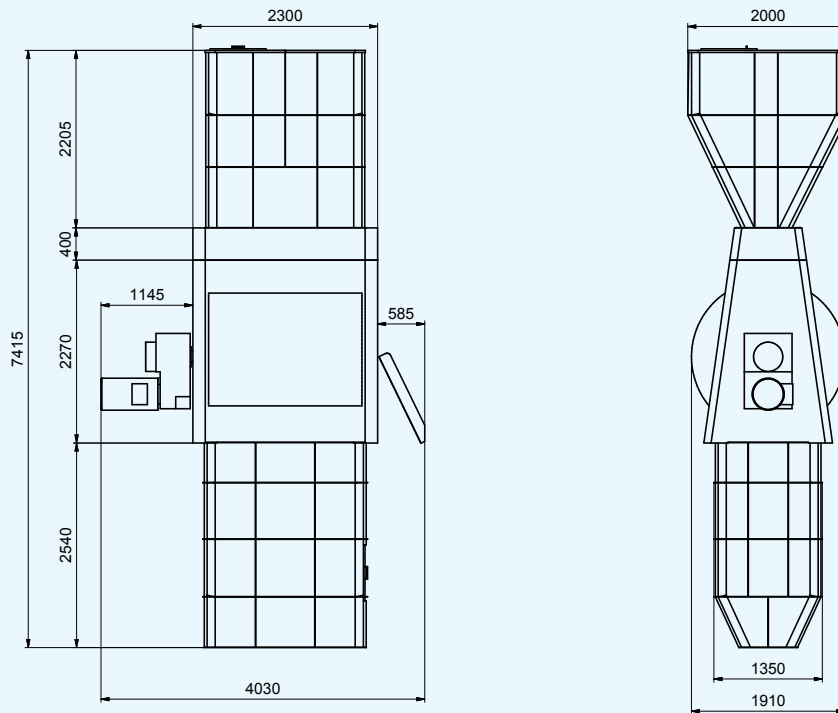

Dimensions in mm



Technical data

OptiMix	
Working volume	4000 liters (25-100% filling)
Product density	Up 0.6 g/cm ³
Motor power	45 kW
Weight incl. motor	4100 kg
Batch sizes	25-100%
Batch frequency (theoretically)	Up to 28 batches per hour (dry mix)
Mixing time	90 seconds (dry mix)
Shaft speed	31 rpm
CV	90 seconds = <5%
Addition	add up to 8 liquids
Option	Air sealing for outlet
Option	Trough in stainless steel ISO 304

ANDRITZ Feed & Biofuel A/S

Glentevej 5-7
6705 Esbjerg, Denmark
Phone: +45 72 160 300
andritz-fb.dk@andritz.com
www.andritz.com/ft